

SWIVEL TAILWHEEL LG-207 REB/REN/MAV

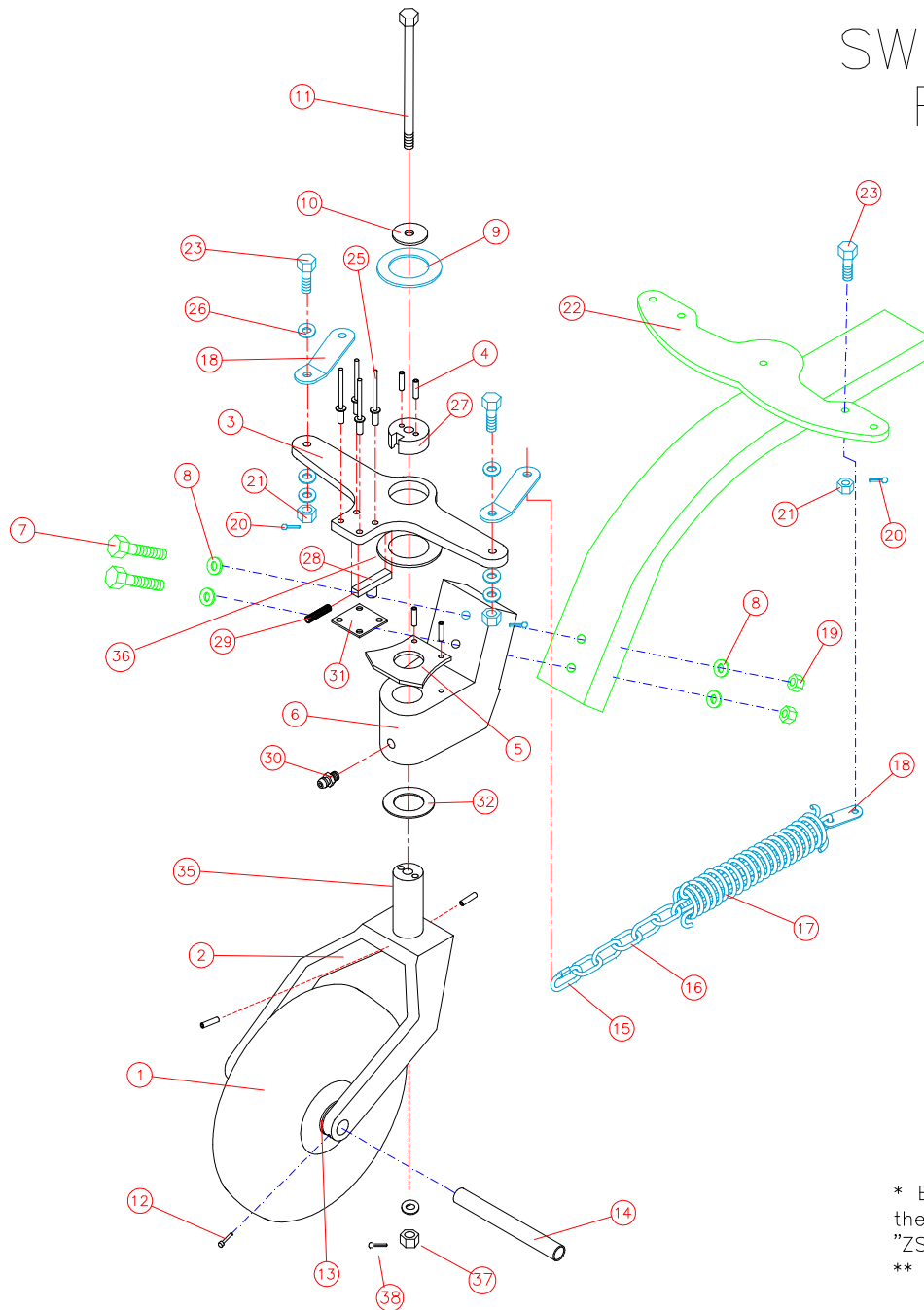

No.	Description	Part #	Req.
1	Castor Wheel	6 x 225	1
2	Tailwheel Yolk	LG-19	1
3	Swivel Steering Bar	LG-54	1
4	1/8" x 1/2" Split Pins	SP-24	4
5	Cam	LG-58	1
6	Tail Wheel Swivel	LG-18	1
7	1/4" Bolts	AN4-17A	2
8	1/4" Washer	AN960-416	5
9	Washer	AN960-1616LT	1
10	1/4" Penny Washer	AN970-4	1
11	1/4" Bolt	AN4-34	1
12	3/32" x 1/2" Socket Cap Screws	BRI-622	2
13	1/2" Steel Flat Washers	SAE-PLTD	4
14	Tail Wheel Axle	LG-21	1
15	1/8" Quick Link (NOT IN LG-207)	158003	2
16	Chain (NOT INCLUDED IN LG-207)	#80 SASH	8"
17	Compression Spring (NOT IN LG-207)	091815	2
18	Hummer Tang	T12-HT6	4
19	1/4" Fiber Nut	AN365-428A	2
20	Cotter Pin	MS24665-132	4
21	Castle Nut	AN310-3	4
22	Rudder Horn (NOT INCLUDED IN LG-207)	RU-26-1**	1
23	3/16" Drilled Bolt	AN3-6	4
25	1/8" x 3/8" SS Rivet	RR-5406	4
26	3/16" Washer	AN960-10	6
27	Cap	LG-57	1
28	Slider Pin	LG-55	1
29	Pin Return Spring	C-526	1
30	Grease Nipple	GF-641	1
31	Spring Plate	LG-59	1
32	Washer	AN960-1216L	1
33	5/16" Washer	AN960-516	6
35	Tail Wheel Shaft	TW-13	1
36	Washer	AN960-1616L	1 or 2
37	Castle Nut	AN310-4	1
38	Cotter Pin	MS24665-132	1

* Blue & green(gray in b/w hardcopy) colored parts will not be included in the assembly of LG-207. They will be shipped separately (See shiplist "ZS-RB#SWIVEL").

** RU-15 for MAVERICK